

NH000 gG 40A/500V



Specifications

| | |
|--------------------------------|-----------------------------------|
| ETI Code | 004181210 |
| Description | NH000 gG 40A/500V |
| Class name | Fuse link |
| Type | NH |
| Size | NH000 |
| Rated current (A) | 40A |
| Rated AC voltage (V) | 500V |
| Rated DC voltage (V) | 250V |
| Characteristics | gG |
| Breaking capacity AC (kA) | 120kA |
| Indicator | Combination fuse status indicator |
| Power dissipation (W) | 3.4W |
| Operating joule integral (A2s) | 16000 |
| Prearcing joule integral (A2s) | 3300 |
| Application | For cable protection |
| Standards | IEC 60269-1, IEC 60269-2 |
| efuse | 1 |

[Online product page](#)

Other documentation



[Technical data catalogue](#)
[Certificate](#)
[3D Model](#)
[2D File](#)
[Instruction manual](#)
[CE declaration](#)
[Eplan file](#)

ETIM international classification

| | |
|--------------------------------------|---|
| Classification | EC000055 |
| Class name | Low Voltage HRC fuse |
| Construction size | NH000 |
| Rated current | 40 |
| Rated voltage | 500 |
| Voltage type | AC |
| Rated switching capacity | 120 |
| Utilization category | gL/gG (cable protection/equipment protection) |
| Type of fuse status indicator | Combination fuse status indicator |
| Insulated metal gripping lugs (IMGL) | No |

Dimension drawing

| | A | B | C | D | E | F | G | H | I | J | K | |
|-----------|-----|----|----|----|----|-----|-----|-----|-----|----|---|---------|
| NV00C | 79 | 53 | 47 | 35 | 15 | 21 | 52 | 7,5 | | | | 6 kombi |
| NV00C I | 79 | 53 | 47 | 35 | 15 | 21 | 52 | 7,5 | | | | 6 kombi |
| NV00 | 79 | 53 | 47 | 35 | 15 | 28 | 56 | 12 | | | | 6 kombi |
| NV00 I | 79 | 53 | 47 | 35 | 15 | 28 | 56 | 12 | | | | 6 kombi |
| NV0 | 125 | 68 | 65 | 35 | 15 | 28 | 56 | 12 | | | | 6 kombi |
| NV1C | 135 | 68 | 65 | 40 | 15 | 28 | 61 | 12 | | | | 6 kombi |
| NV1C I | 135 | 68 | 65 | 40 | 15 | 28 | 61 | 12 | | | | 6 kombi |
| NV1 | 135 | 72 | 65 | 40 | 20 | 46 | 65 | 14 | | | | 6 kombi |
| NV1 I | 135 | 72 | 65 | 40 | 20 | 46 | 65 | 14 | | | | 6 kombi |
| NV2C | 150 | 72 | 65 | 48 | 20 | 46 | 73 | 14 | | | | 6 kombi |
| NV2C I | 150 | 72 | 65 | 48 | 20 | 46 | 73 | 14 | | | | 6 kombi |
| NV2 | 150 | 72 | 65 | 48 | 26 | 54 | 73 | 14 | | | | 6 kombi |
| NV2 I | 150 | 72 | 65 | 48 | 26 | 54 | 73 | 14 | | | | 6 kombi |
| NV3C | 150 | 72 | 65 | 60 | 26 | 54 | 84 | 14 | | | | 6 kombi |
| NV3 | 150 | 72 | 65 | 60 | 33 | 65 | 84 | 14 | | | | 6 kombi |
| NV4 | 200 | 75 | 66 | 87 | 50 | 100 | 121 | 24 | 150 | 16 | | 8 |
| NV4a | 200 | 99 | 87 | 85 | 50 | 95 | 121 | 27 | | | | 6 |
| NV4a SI* | 200 | 99 | 87 | 85 | 50 | 95 | 121 | 27 | | | | 6 |
| NV1/1000V | 155 | 90 | 87 | 40 | 20 | 45 | 59 | 9 | | | | 6 |

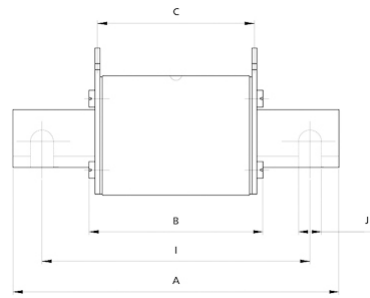

| | Striker pin | | | |
|-----|-------------|------|------|-----|
| | K | L | M | S1 |
| 00C | 0 | 20.7 | 16.7 | 7.5 |
| 00 | 0 | 20.7 | 16.7 | 7.5 |
| 1 | 13.7 | 19.7 | 25 | 12 |
| 2 | 16.2 | 27.4 | 25 | 12 |
| 3 | 17 | 35.6 | 25 | 12 |
| 4a | 24 | 49 | 25 | 12 |

