

# SSQ 225



## Specifications

|  |                               |
|--|-------------------------------|
| ETI Code                                   | 002421424                     |
| Description                                | SSQ 225                       |
| Class name                                 | Center-off change-over switch |
| function                                   | Center-off change-over switch |
| Rated current (A)                          | 25A                           |
| Rated AC voltage (V)                       | 400V                          |
| Number of poles                            | 2                             |
| IP rating                                  | IP20                          |
| Max input cross-section (mm <sup>2</sup> ) | 16mm <sup>2</sup>             |
| Rated Frequency (Hz)                       | 50Hz/60Hz                     |
| Standards                                  | 60947-3                       |

[Online product page](#)

## Other documentation



[Technical data catalogue](#)

[3D Model](#)

[2D File](#)

[Instruction manual](#)

[CE declaration](#)

[Eplan file](#)

## ETIM international classification

|   |                                    |
|---|------------------------------------|
| Classification                            | EC001545                           |
| Class name                                | Main switch for distribution board |
| Switching function                        | Two-way switch                     |
| Number of contacts as change-over contact | 1                                  |
| Number of poles                           | 2                                  |
| Rated current                             | 25A                                |
| Rated voltage                             | 400V                               |
| Min. rated voltage                        | 10V                                |
| Voltage type                              | AC                                 |
| With signal lamp                          | No                                 |
| Width in number of modular spacings       | 2                                  |
| Built-in depth                            | 70mm                               |
| Degree of protection (IP)                 | IP20                               |

# Dimension drawing

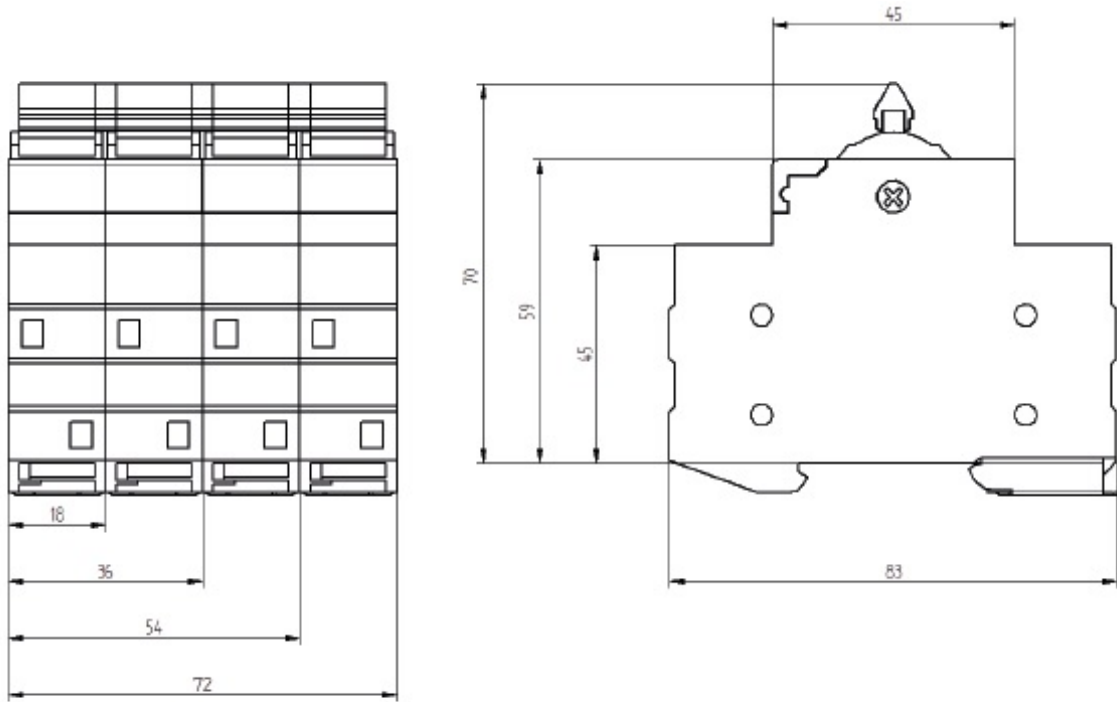

## Symbol/Connection

